

AERODROME GROUND MOVEMENT CHART - ICAO	CENTRAL APRON ELEV	16 m	TWR	118.05	118.1	240.9
	THE OTHER APRON ELEV	13 m	GND	121.9	121.95	
			APN	129.525	130.875	131.175

SEOUL / Gimpo INTL
RWY 14L/32R
RWY 14R/32L DEPARTURE

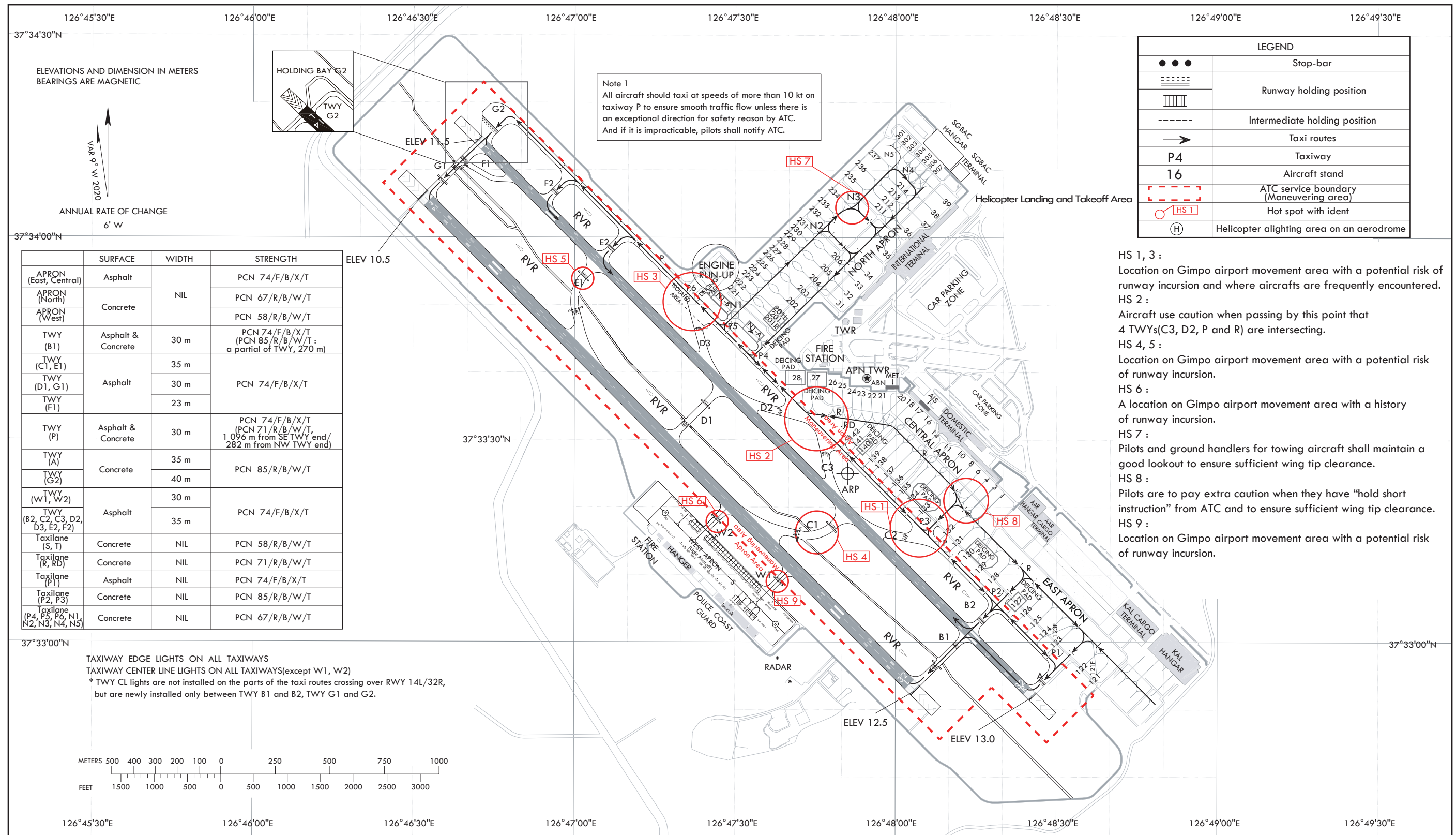

Change : Information of intermediate holding position.

**AERODROME GROUND
MOVEMENT CHART - ICAO**

CENTRAL APRON ELEV **16 m**
THE OTHER APRON ELEV **13 m**

TWR	118.05	118.1	240.9
GND	121.9	121.95	
APN	129.525	130.875	131.175

SEOUL / Gimpo INTL
RWY 14L/32R
RWY 14R/32L ARRIVAL

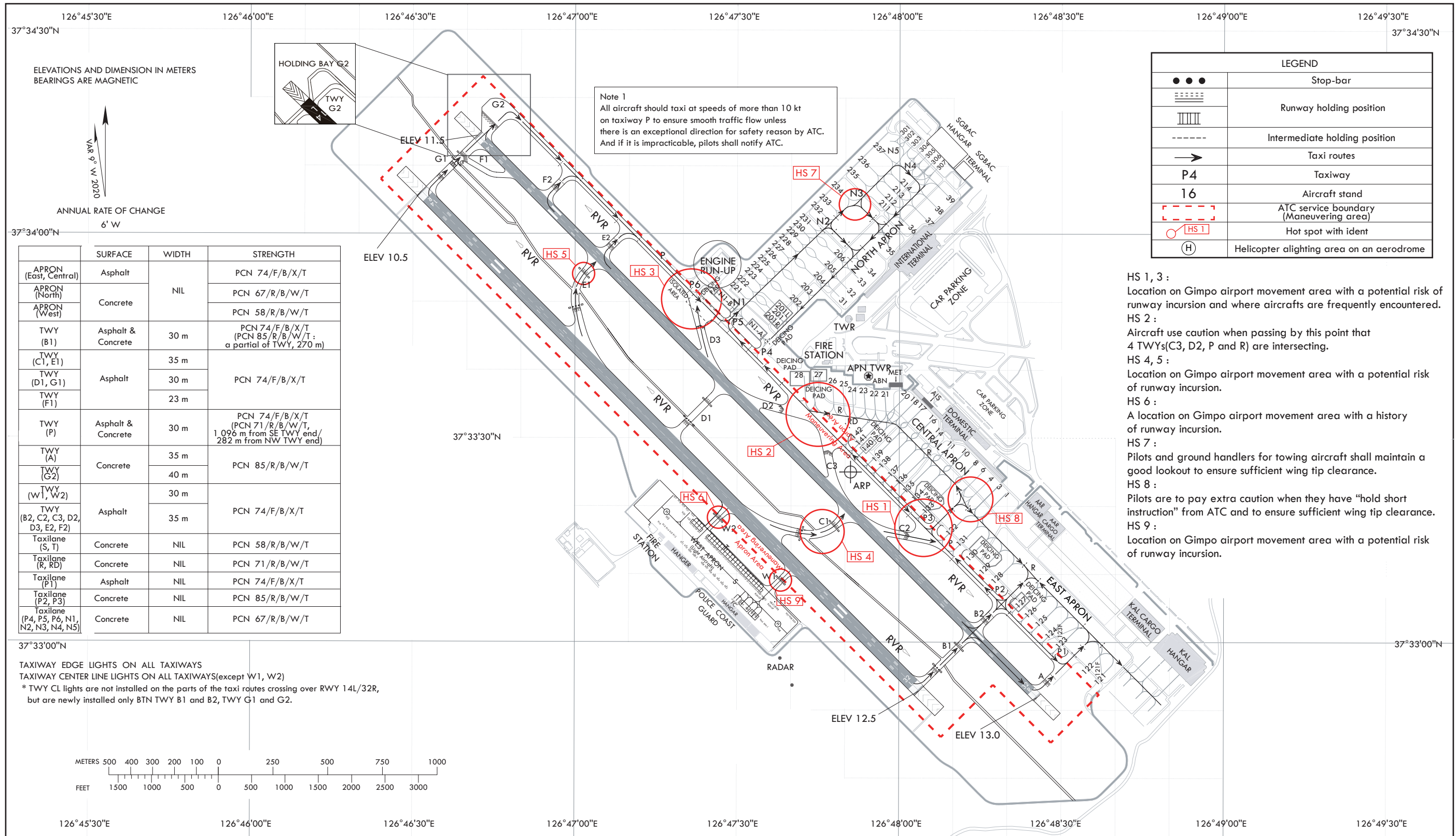

HS 1, 3 :
Location on Gimpo airport movement area with a potential risk of runway incursion and where aircrafts are frequently encountered.
HS 2 :
Aircraft use caution when passing by this point that 4 TWYs(C3, D2, P and R) are intersecting.
HS 4, 5 :
Location on Gimpo airport movement area with a potential risk of runway incursion.
HS 6 :
A location on Gimpo airport movement area with a history of runway incursion.
HS 7 :
Pilots and ground handlers for towing aircraft shall maintain a good lookout to ensure sufficient wing tip clearance.
HS 8 :
Pilots are to pay extra caution when they have "hold short instruction" from ATC and to ensure sufficient wing tip clearance.
HS 9 :
Location on Gimpo airport movement area with a potential risk of runway incursion.

Change : Information of intermediate holding position.